

 SENNHEISER

HME 26



Instruction manual

Safety instructions

- Please read these instructions carefully and completely before using the headset.
- Make these instructions easily accessible to all users at all times.
- Always include these instructions when passing the headset on to third parties.
- The headset is capable of producing sound pressure levels exceeding 85 dB(A). In many countries 85 dB(A) is the maximum legally permissible level for continuous noise exposure during the working day. Exposure to sounds of higher volume levels or for longer durations can permanently damage your hearing!
- Never repair or attempt to repair a defective headset yourself. Contact your Sennheiser agent or the Sennheiser Service Department.
- Only replace those parts of the headset whose replacement is described in this manual. All other parts of the headset must be replaced by your Sennheiser agent.
- Protect the headset from wetness. Use only a slightly damp cloth to clean the headset. For information on how to clean the headset, contact your Sennheiser agent.

Intended use of the headset

Intended use includes:

- having read this instruction manual especially the chapter "Safety instructions".
- using the headset in jet aircraft and within the operating conditions as described in this instruction manual.

Improper use

Improper use means using the headset other than as described in this instruction manual, or under operating conditions which differ from those described herein.

HME 26 headset

The HME 26 headset features dynamic, closed headphones. The noise-compensating condenser microphone ensures excellent speech transmission even in noisy environments. Designed for use in aircraft cockpits.

Features

- Lightweight
- Extremely comfortable to wear due to the patented two-piece automatic headband and soft ear pads
- Peak level protection (switchable) safeguards you from volume peaks above 110 dB
- “Flip-away” headphone allows single-sided listening
- Flexible microphone boom, can be worn on either left or right-hand side
- Noise-compensating condenser microphone ensures excellent speech transmission
- Single-sided cable, easy to exchange
- Volume control integrated in the cable (HME 26-V-K only)
- ETSO approval C57a/C58a

Delivery includes

- 1 HME 26 headset
- 1 cable clip
- 1 wind and pop screen
- 1 instruction manual
- 1 carry bag
- 1 EASA Form 1

Operation

Turning the microphone boom

The microphone boom can be rotated. This allows the headset to be worn with the microphone boom positioned on either the left or right-hand side of the head.

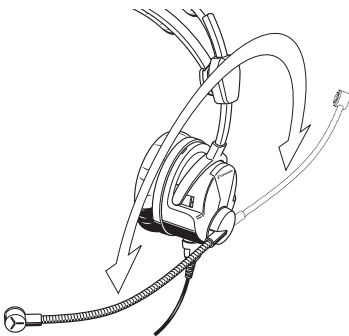

Putting on the headset

When putting on the headset, the patented two-piece headband adjusts automatically.

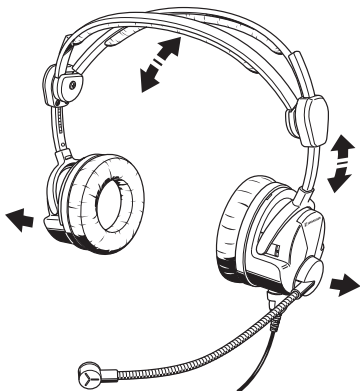

Positioning the microphone

Bend the flexible microphone boom so that the microphone is placed at the corner of the mouth. Maintain a distance of approx. 2 cm between microphone and mouth. Always use the supplied wind and pop screen.

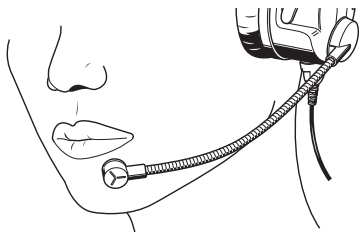

Flipping away one earcup

The headset features a “flip-away” earcup for single-sided listening.



Adjusting the volume directly on the audio system

Connect the headset to the corresponding sockets of your audio system. Adjust the volume directly on the audio system.

CAUTION! Hearing damage due to high volumes!

This headset is capable of producing high sound pressure levels. Higher volumes or longer durations can damage your hearing!

Set the volume to a medium level. Make sure that you can hear critical sounds such as warning alarms.

Adjusting the volume via the slide volume controls (HME 26-V-K only)

The two slide volume controls **1** and **2** allow you to adjust the volume for the left and right channel separately.

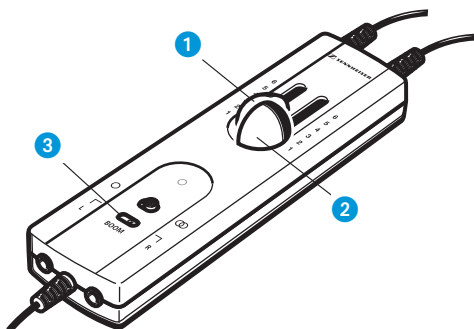

Changing the left and right audio channel (HME 26-V-K only)

The position "R" or "L" of the BOOM switch **3** corresponds to the position of the microphone on the left or right side of the mouth. When the microphone boom is rotated to permit left or right side microphone orientation, the BOOM switch allows you to correctly assign the audio channels (L/R) to the appropriate headphone sides. This enables the correct orientation of the volume controls and any audio signals. To move the BOOM switch, use a pointed tool.

Adjusting the microphone sensitivity

The microphone sensitivity has been factory pre-set to 80 mV/Pa as per RTCA DO-214. You can change the microphone sensitivity by turning a small screwdriver in the direction of the arrow.

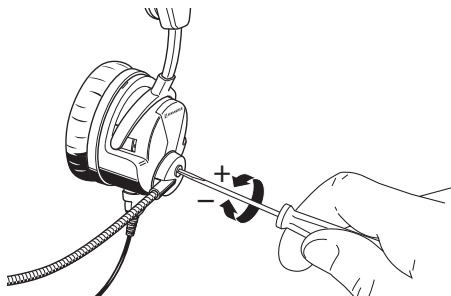

Switching the peak level protection on and off

The peak level protection safeguards your ears from volume peaks above 110 dB, which can be transmitted via the audio system or radio equipment. The peak level protection is factory-preset to "on". You can switch the peak level protection off by gently sliding the switch to the upper position using a pointed tool.

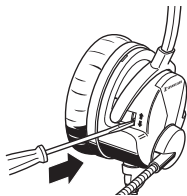

Care and maintenance

Cleaning the headset

Use a soft, slightly damp cloth to clean the headset from time to time. If the headset is very dirty, use a cloth dampened with mild, soapy water. Do not use any solvents or cleansing agents.

CAUTION! Danger of short-circuit due to the ingress of water!

Water entering the housing of the headset can cause a short-circuit and damage the electronics.

Replacing the earpads

For reasons of hygiene, the black earpads should be replaced from time to time. Grasp the edge of the earpad and pull sharply. Attach the new earpad to the earcup by pressing firmly around the earpad until you hear the 12 latches lock into place. Repeat for the other earcup.



Accessories and spare parts

By changing the cable, you can simply retrofit your headset (see “Product variants” on page 11).

- Cable -C Cat. No. 500840
- Cable -K Cat. No. 500841
- Cable -N Cat. No. 500843
- Cable -V-K Cat. No. 500847
- MZQ 2002 cable clip Cat. No. 044740
- HZC 08 cable clip Cat. No. 525787
- Headband padding, 1 pair Cat. No. 515629
- Earpads, leatherette, 1 pair Cat. No. 529766
- Earpads, leatherette, 100 pairs Cat. No. 529767
- Earpads, velour, 1 pair Cat. No. 532724
- HZH 26 hygiene pads, 200 pairs Cat. No. 502595
- Wind and pop screen, 1 item Cat. No. 515297
- Wind and pop screen, any quantity Cat. No. 514127
- Carry bag Cat. No. 077408

Cable clips

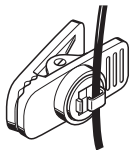

HZC 08
(for round cable only)

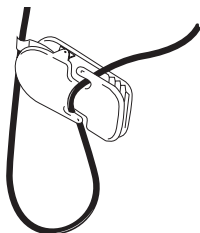

MZQ 2002
(for round or flat cable)

Product variants

Variant (Cat. No.) (Part Number)	Description	Single-sided round cable
HME 26* (502395) (026-55)	Headset with condenser microphone	–
HME 26-K (502396) (026-55-999-0131)	Headset with condenser microphone	with ¼" (6.3 mm) jack plug (headphones) and PJ-068 equivalent (microphone), length 1.85 m

* This is the headset supplied without a cable and must be used with one of the cables listed above (see page 10)

Connector assignment

HME 26-K

1/4" (6.3 mm) jack plug

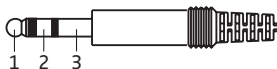

- 1 Audio Hi
- 2 not assigned
- 3 Audio Lo

PJ-068 equivalent

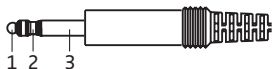

- 1 not assigned
- 2 Microphone Hi
- 3 Microphone Lo

Cable -C

Solder side

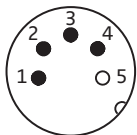

- 1 Audio Hi
- 2 Audio Lo
- 3 Microphone Hi
- 4 Microphone Lo
- 5 not assigned

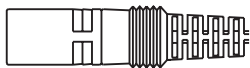

Cable -N

Solder side



- 1 Audio Hi
- 2 Audio Lo
- 3 not assigned
- 4 Microphone Lo
- 5 Microphone Hi
- 6 not assigned
- 7 not assigned
- 8 not assigned



Cable -V-K

1/4" (6.3 mm) jack plug

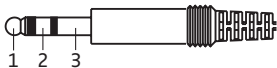

- 1 Audio Hi left
- 2 Audio Hi right
- 3 Audio Lo

PJ-068 equivalent

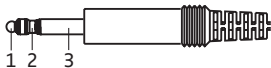

- 1 not assigned
- 2 Microphone Hi
- 3 Microphone Lo

Specifications

HME 26 headsets

Headphones

Transducer principle	dynamic, closed
Ear coupling	supra-aural
Frequency response	20–14,000 Hz
Impedance mono/stereo	600 Ω /1,200 Ω
Characteristic SPL	92 dB SPL at 1 kHz, 1 mW, mono 97 dB SPL at 1 kHz, 1 V
Max. SPL	120 dB SPL at 1 kHz (peak level protection = ON) > 125 dB SPL at 1 kHz (peak level protection = OFF)
THD	< 1 % at 110 dB SPL (350–3,000 Hz)
Contact pressure	approx. 3.6 N

Microphone

Type	MKE 46
Transducer principle	pre-polarized condenser microphone, noise-compensating
Frequency response	100–6,000 Hz
Output voltage	adjustable from 17–100 mV/Pa, 80 mV/Pa -2 dB (factory pre-set) \cong 800 mV -2 dB at 114 dB SPL
Terminating impedance	150–2,200 Ω
Supply voltage	8–16 V DC

General data

Temperature range	operation: $-15\text{ }^{\circ}\text{C}$ to $55\text{ }^{\circ}\text{C}$ storage: $-55\text{ }^{\circ}\text{C}$ to $70\text{ }^{\circ}\text{C}$
Weight without cable	approx. 200 g

Manufacturer Declarations

Warranty

Sennheiser electronic GmbH & Co. KG gives a warranty of 5 years on this product.

For the current warranty conditions, please visit our web site at www.sennheiser.com or contact your Sennheiser partner.

CE Declaration of Conformity

 This equipment is in compliance with the essential requirements and other relevant provisions of Directive 89/336/EU. The declaration is available at www.sennheiser.com.

Before putting the device into operation, please observe the respective country-specific regulations!

